

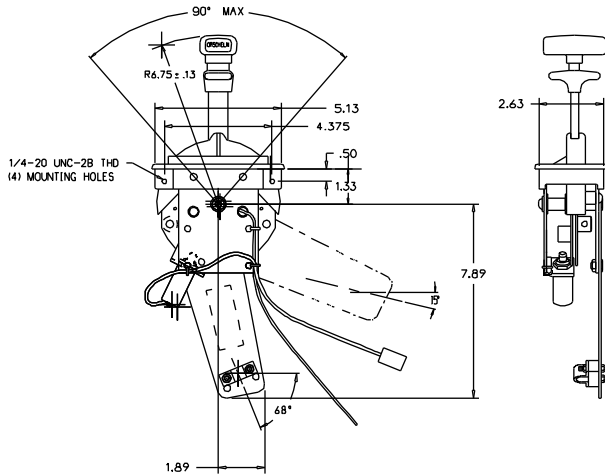

ALLISON 1000/2000 SHIFT SYSTEM

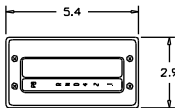

PICTURE SHOWN WITH INTERLOCK (PARK SOLENOID)

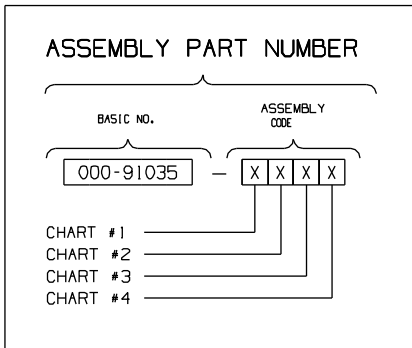
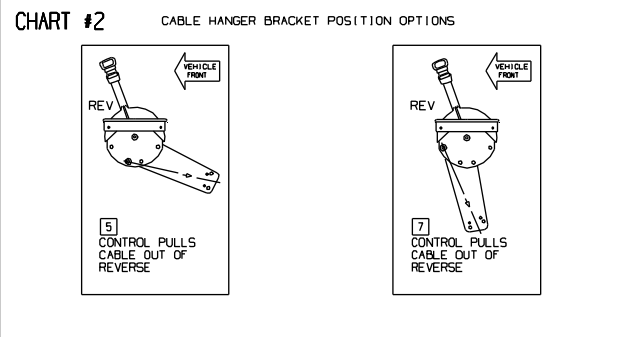
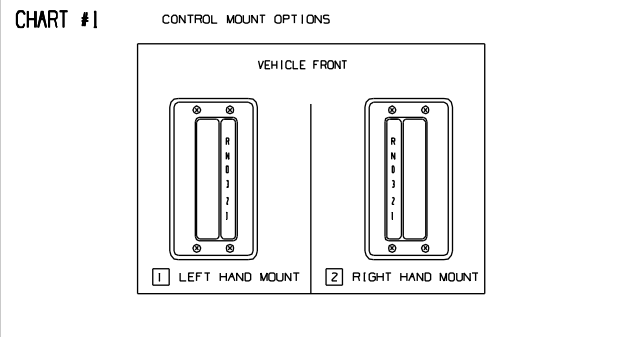
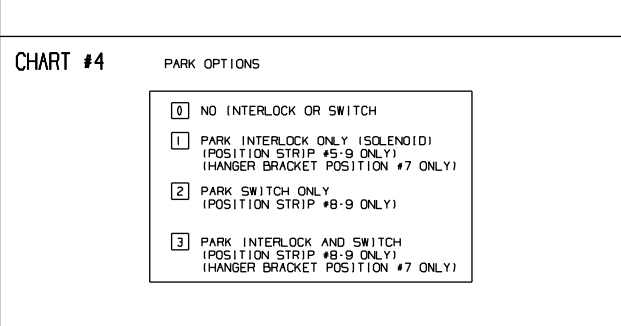

CHART #3 POSITION STRIP OPTIONS

R N D 3 2 1	R N D ① 3 2 1	R N D ① 3 2 1	R N D ① 4 3 2 1	P R N D 3 2 1	P R N D ① 3 2 1	P R N D ① 4 3 2 1	PB R N D 3 2 1	PB R N D ① 3 2 1
1	2	3	4	5	6	7	8	9



CABLE 100-04333-LGTH

STANDARD PUSH-PULL CABLE.
 3 INCH TRAVEL, CLAMP STYLE ENDS.
 ALL STEEL PARTS ARE PLATED OR STAINLESS STEEL.

TRANSMISSION KIT 000-59534-0000

ONE KIT FOR PARK AND NON-PARK OPTION.
 ALL PARTS ARE PLATED STEEL.
 INCLUDES ALL ATTACHMENT HARDWARE.
 LEVER HOLES IDENTIFIED FOR PARK OPTION.

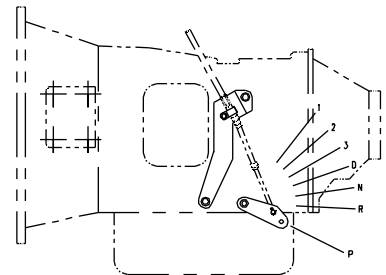

OTHER CONFIGURATIONS MAY BE AVAILABLE, CONTACT ORSCHELN AT 660/263-4377.

ORSCHELN PRODUCTS, LLC
 1177 N. MORLEY
 MOBERLY, MO 65270